

SUPER-AIR.com

GUIDE TIRE INFLATION SYSTEM

MN605V1.2
30/01/2024

1 – GENERAL CHARACTERISTICS

- Power supply: From 12Vdc to 30 Vdc. (Automatic source)
 - Use 2A fuse.
 - Use a line filter to keep the air in the product free of impurities.
 - Minimum operating pressure 80 psi / 5.5 bar.
 - Maximum operating pressure 140 psi / 9.7 bar.
 - Minimum operating pressure of lines 40 psi / 2.7 bar.
 - Maximum operating pressure of the lines 140 psi / 9.7 bar.
 - Connection for 8x1 mm nylon hoses.
 - Operating and storage temperature: -10°C to + 60°C.
- (Values that exceed the limits above, characterize the loss of guarantee of the product).

2 – INTRODUCTION

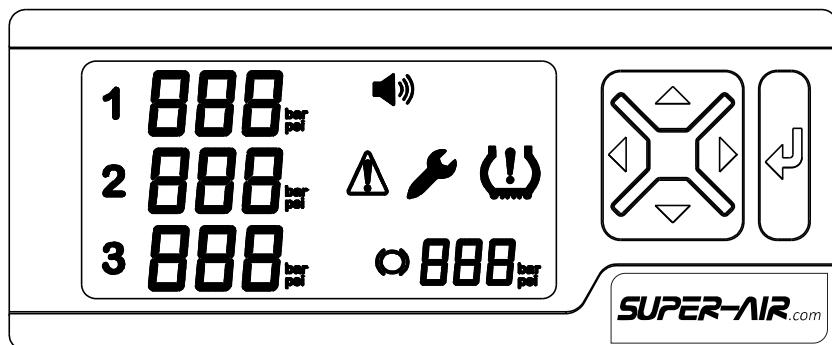

- | | |
|---------------------------------|-------------|
| 1 LINE 1 PRESSURE OUTLET | △ KEY UP |
| 2 LINE 2 PRESSURE OUTLET | ▽ KEY DOWN |
| 3 LINE 3 PRESSURE OUTLET | ◀ KEY LEFT |
| ○ COMPRESOR AIR INLET ICON | ▶ KEY RIGHT |
| 🔧 FAULT ICON | ↵ KEY OK |
| 🔊 AUDIBLE ALARM SIGNAL ICON | |
| 🚗 LOW PRESSURE TIRE ICON | |
| ⚠ OVER PRESSURE ICON | |

3 – PROGRAMMING THE CONTROLLER WORKING MODE

To access the controller work mode settings, press the **OK** key for 5 seconds, the display will show: **CLAVE**, requesting the access password. The factory password is **212**. Use the **UP** and **DOWN** keys to Enter the password, the **RIGHT** key to toggle between the digits and the **OK** key to confirm. If the password is correct, the equipment will enter the programming menu.

Use the **UP** and **DOWN** keys to adjust the desired values and the **RIGHT** and **LEFT** keys to navigate between the functions. To save the settings and exit, you must go to the last function by pressing the **OK** key, or the **RIGHT** key.

DISPLAY	DESCRIPTION	SETTING	DEFAULT
<i>F01</i>	Unit of measurement.	bar or psi	psi
<i>F02</i>	Pressure line 3.	ON or OFF	OFF
<i>F03</i>	Minimum pressure in the compressor to allow the product to work.	80 psi to 140 psi 5.5 bar to 9.7 bar	100 psi 6.9 bar
<i>F04</i>	Line 1 pressure setpoint.	40 psi to 140 psi 2.7 bar to 9.7 bar	100 psi 6.9 bar
<i>F05</i>	Line 2 pressure setpoint.	40 psi to 140 psi 2.7 bar to 9.7 bar	100 psi 6.9 bar
<i>F0b</i>	Line 3 pressure setpoint. Visible if <i>F02</i> =ON.	40 psi to 140 psi 2.7 bar to 9.7 bar	100 psi 6.9 bar
<i>F07</i>	Silenced audible warning time.	15 min or 30 min	15 min
<i>F08</i>	Minimum pressure in the lines to allow the product to work.	0 psi to 90 psi 0.0 bar to 6.2 bar	80 psi 5.5 bar
<i>F09</i>	Display colors.	1-White 2-Ámbar 3-Blue 4-Green	1
<i>F10</i>	Change Password.	000 to 999	212
<i>F11</i>	Overpressure alert.	SI or NO	SI
<i>F12</i>	Interval between telemetry codes.	1 min to 5 min	1 min
<i>F13</i>	Correction in line 1 pressure reading.	0 psi to 10 psi 0.0 bar to 1.0 bar	0 psi
<i>F14</i>	Correction in line 2 pressure reading.	0 psi to 10 psi 0.0 bar to 1.0 bar	0 psi
<i>F15</i>	Correction in line 3 pressure reading.	0 psi to 10 psi 0.0 bar to 1.0 bar	0 psi
<i>F1b</i>	Electro valve box firmware version.	-	-
<i>F17</i>	Restore to factory data.	SI or NO	NO

4 – OPERATION

When turned on, the product enters standby mode, waiting for the compressor pressure to reach the value programmed in *F03*. In this mode, the compressor icon remains on in the display color programmed in *F09*. The lines remain off until the compressor reaches the pressure programmed in *F03*. After stabilization of the pressure in the compressor, all output lines are activated maintaining the pressure programmed in *F04*, *F05* and *F0b*. When activated, the corresponding line number starts to flash. If the pressure of any of the lines falls below the value programmed in, *F08* and the line is turned off.

It is possible to silence the audible warning by pressing the **OK** key, the alert will remain silent for the time programmed in *F07*.

Pressing the **DOWN** key for 5 seconds, the equipment will be turned off manually, and it can be turned on if the **DOWN** key is pressed for 5 seconds again.

Pressing the **UP** key for 5 seconds, the equipment will emit an audible warning, activating the 'fast inflate' function, this function will only be available if the pressure of any of the lines is 10% below the value programmed in *F04*, *F05* or *F0b*. This function will be active for 45 minutes or until the line pressure reaches 95% of the programmed value, the key led will flash red while the "fast inflate" function is active. Whenever the compressor inlet pressure exceeds 140 psi, the use of a pressure regulator is mandatory.

5 – TELEMETRY

Telemetry, 25ms pulses with a 50ms period, interval between codes configurable in *F12*. Error encoding:

PULSES	DESCRIPTION	DISPLAY	SIGNAL EXAMPLE
2	Communication failure	<i>Err</i>	
4	Compressor failure		
6	Compressor pressure sensor failure	<i>Err</i>	
8	Line 1 pressure sensor failure		
10	Line 2 pressure sensor failure		
12	Line 3 pressure sensor failure		
14	Line 1 leaking		
16	Line 2 leaking		
18	Line 3 leaking		
20	Over pressure in the compressor		
22	Over pressure on line 1		
24	Over pressure on line 2		
26	Over pressure on line 3	<i>CLP</i>	
28	Short circuit in solenoid valve 1		
30	Short circuit in solenoid valve 2		
32	Short circuit in solenoid valve 3		

6 – ERROR MESSAGES OR WARNINGS PRESENTED ON THE DISPLAY

DISPLAY	DESCRIPTION
	Compressor icon. It will flash and the display will remain red when the system inlet pressure is 20% below the programmed in <i>F03</i> , at this moment the control is paused until the inlet pressure reaches the value configured in <i>F03</i> . After the pressure has stabilized, the compressor icon will be on and the display will return to the color programmed in <i>F09</i> .
	Reading error, it means that there was a failure in the pressure reading in one of the sensors. The message <i>Err</i> will appear on the pressure line with communication problem. It is recommended to seek technical assistance to resolve the problem.
	Flat tire icon. Shows when the pressure of any of the lines is 10% below the programmed value. The icon will go out when the line pressure reaches the values set in <i>F04</i> , <i>F05</i> , <i>F0b</i> .
	Overpressure alert, this icon will turn on when the pressure of one or more lines exceeds 10% of the programmed pressure.
	Sound warning alert. The audible alarm together with the buzzer icon will appear when the system shows any irregularity in the programmed operation. You can change the warning display time in <i>F07</i> .
<i>UER 14</i>	Product firmware version is shown on the display for 3 seconds whenever the equipment is turned on.
<i>Err</i>	Reading error, it means that there was a failure in the pressure reading in one of the sensors. The maintenance icon will appear on the display together with the message <i>Err</i> on the problem line. It is recommended to seek technical assistance to resolve the problem.
<i>CLP</i>	It means that there is a short circuit in one of the product's solenoid valves. The <i>CLP</i> message will appear on the line with the problem. It is recommended to seek technical assistance to resolve the problem.

7 - DIMENSIONS

- A - PRESSURE CONTROLLER (INV-60501)
- B - FIXING MOLDING
- C - FIXING TAPE FOR RECESSED DIN 1
- D - EXTERNAL FIXING BRACKET
- E - ELECTRO VALVE BOX (INV-60502)

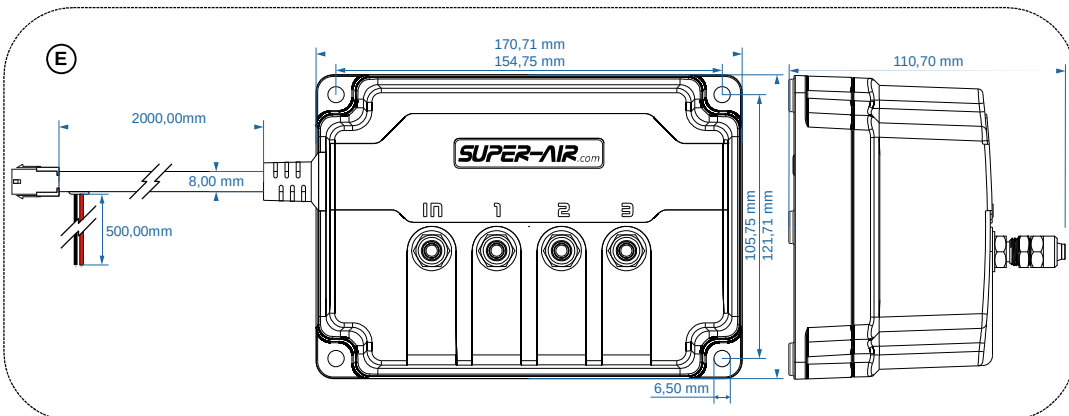
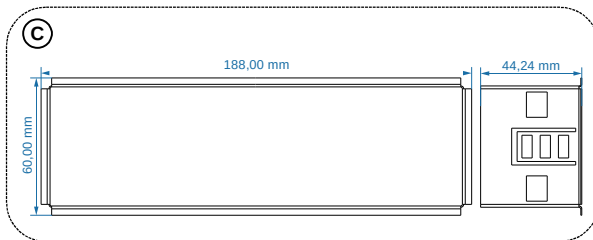
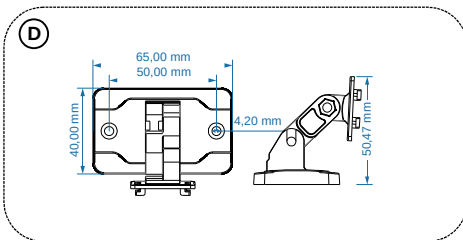
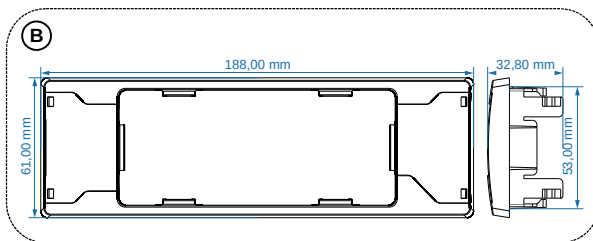
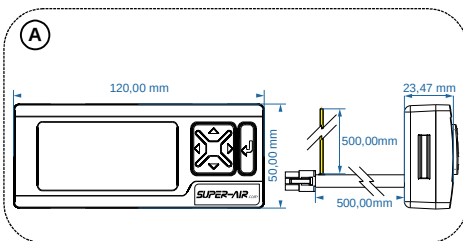

8 - COMPONENTS

- A - PRESSURE CONTROLLER (INV-60501)
- B - FIXING MOLDING
- C - FIXING TAPE FOR RECESSED DIN 1
- D - EXTERNAL FIXING BRACKET
- E - ELECTRO VALVE BOX (INV-60502)

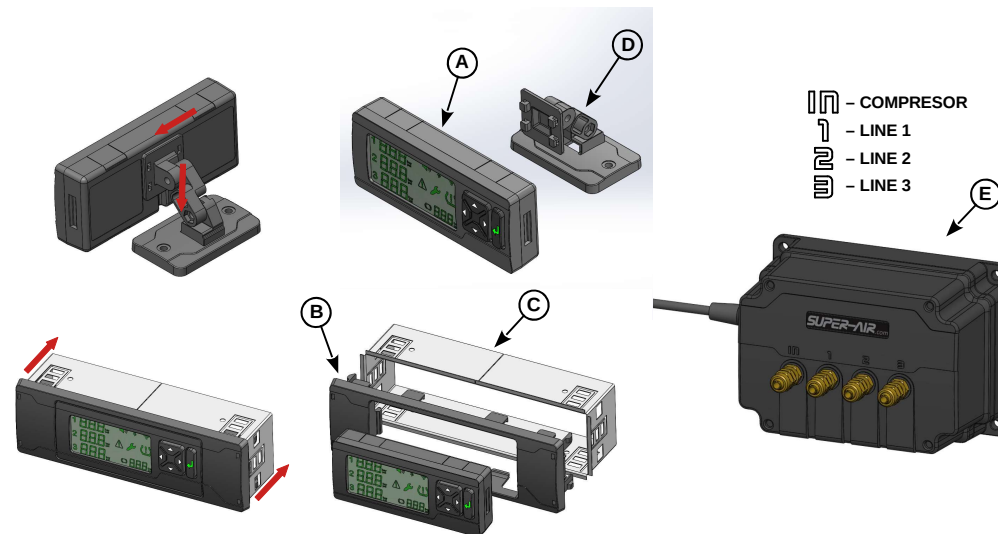

THE MANUFACTURER RESERVES THE RIGHT TO CHANGE ANY SPECIFICATION WITHOUT PRIOR NOTICE.

9 - INSTALATION

